

Garden benches Czardas System



assembly instructions

Thank you for choosing a garden bench from our Czardas System.

All of our seating options are made using **weatherproof, easy-care plastic**. Below you will find the assembly instructions for each bench. The individual parts can be assembled in a **plug-in system and do not require any tools**. You may choose to use a 6–10 mm drill.

Do not hesitate to contact us with any further inquiries:
service@khw-geschwenda.de

Overview of variants



Berlin - Page 3

Item no. 4300...

1 pack



Kopenhagen - Page 6

Item no. 4550...

2 packs



Brüssel - Page 11

Item no. 4410...

1 pack



Amsterdam - Page 17

Item no. 4580...

2 packs

Berlin garden bench content

Item no. 4300...

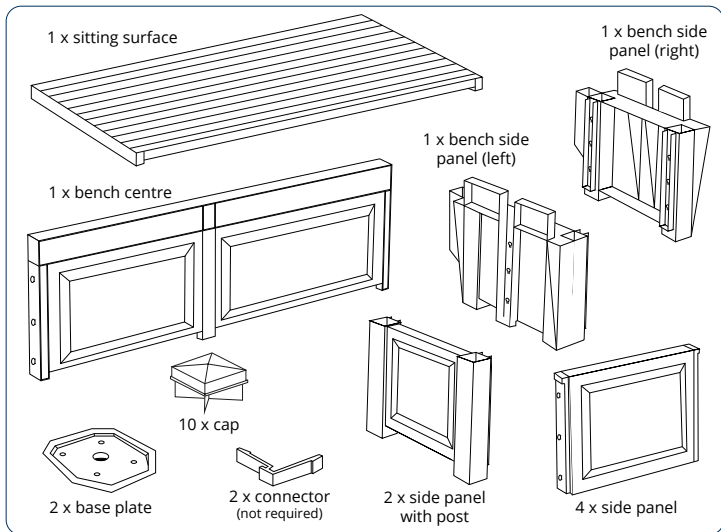

assembly

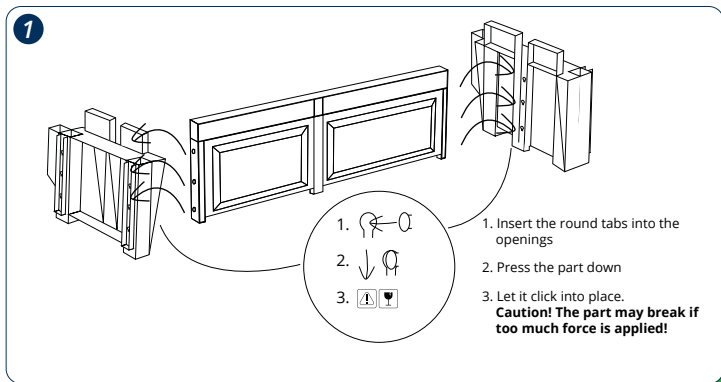

2

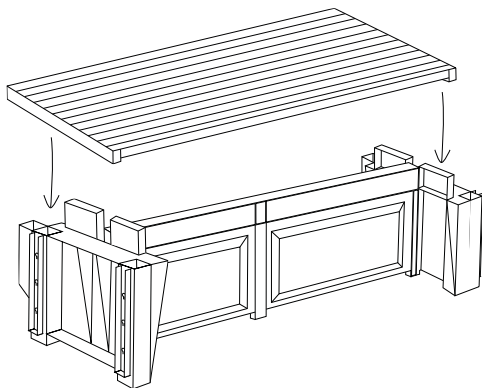

3

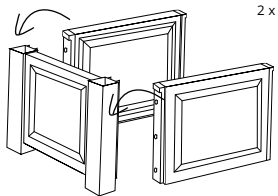

4

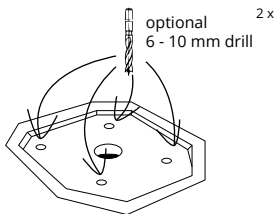

5

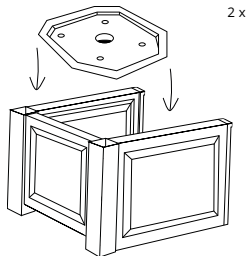

6

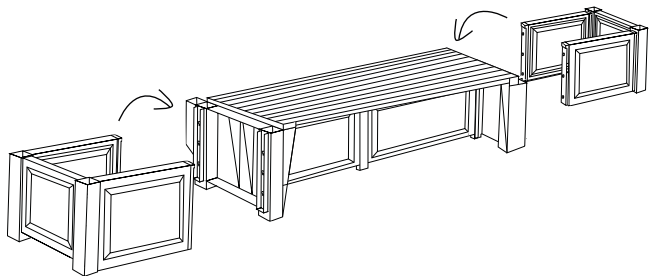

7

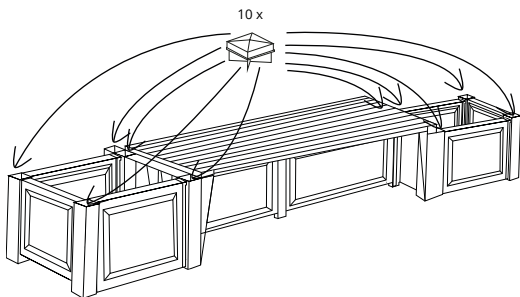

Kopenhagen garden bench content

Item no. 4550...

1 x sitting surface

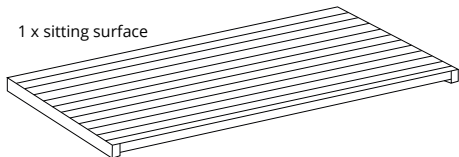

1 x bench side panel (right)

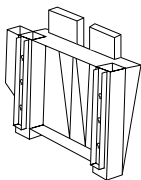

1 x bench centre

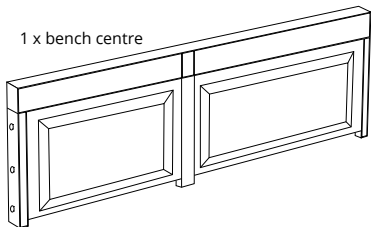

1 x bench side panel (left)

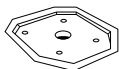
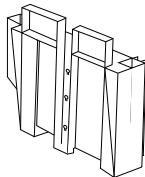

2 x base plate



12 x cap

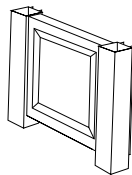

2 x side panel with post

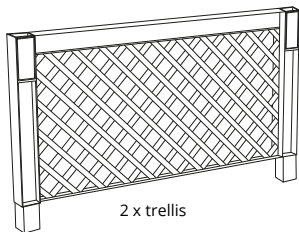

2 x trellis

4 x connector

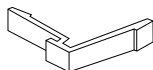

4 x corner connector
(not required)

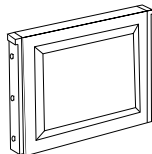

4 x side panel

assembly

1

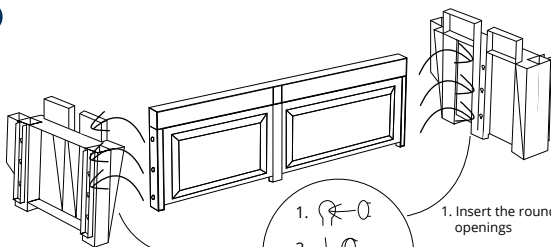

1. 
2. 
3. 

1. Insert the round tabs into the openings

2. Press the part down

3. Let it click into place.

Caution! The part may break if too much force is applied!

2

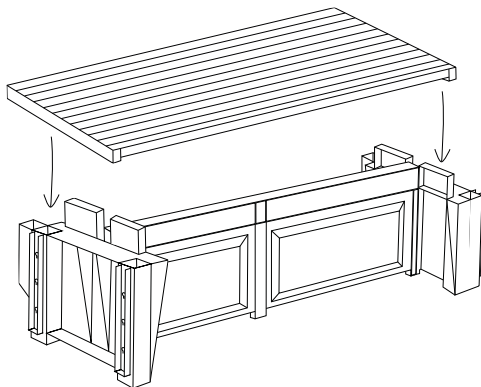

3

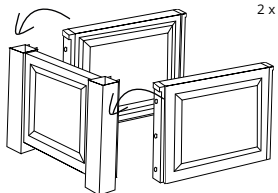

2 x

4

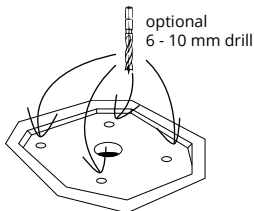

optional
6 - 10 mm drill

2 x

5

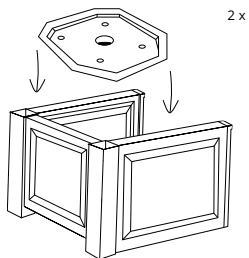

6

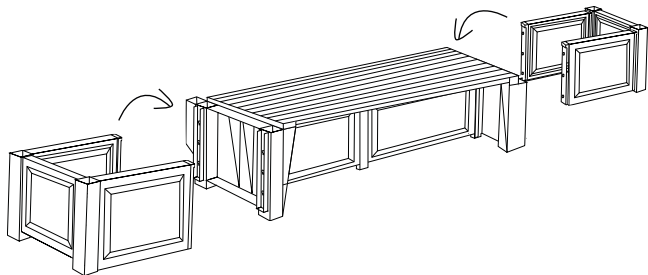

7

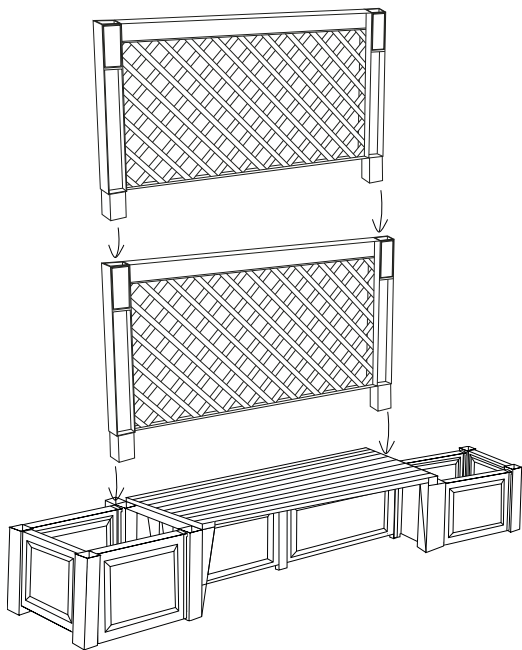

8

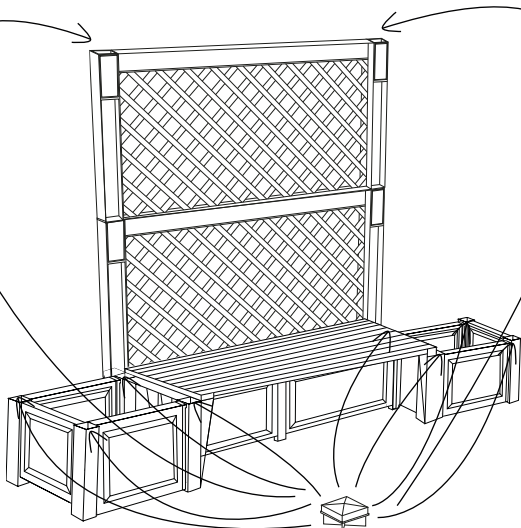

10 x
(Rest = spare parts)

9

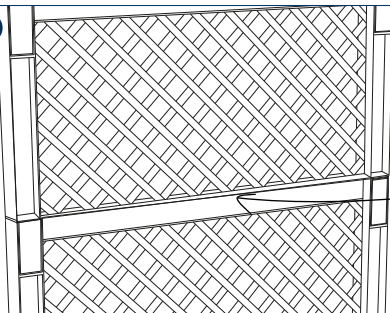

Connect the two
trellises together.

Orientate to the holes!



2 x
(Rest = spare parts)

Brüssel garden bench content

Item no. 4410...

1 x sitting surface

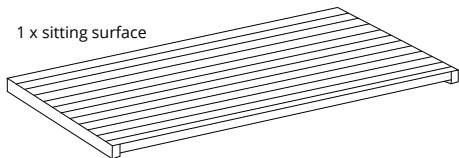

1 x bench side panel (right)

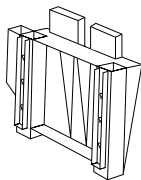

1 x bench centre

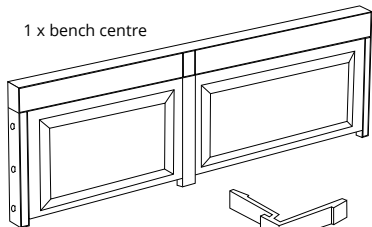

1 x bench side panel (left)

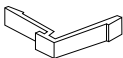
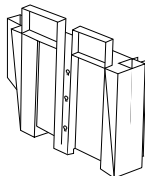

2 x connector
(not required)



10 x cap

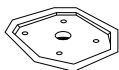

2 x base plate

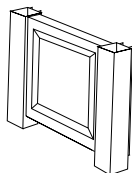

2 x side panel
with post

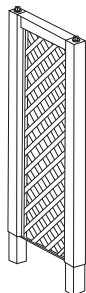

2 x trellis

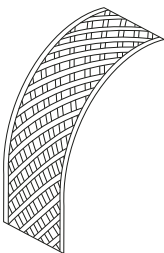

2 x middle panel,
rose arch

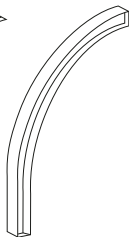

4 x side panel,
rose arch

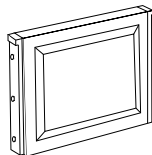

4 x side panel

assembly

1

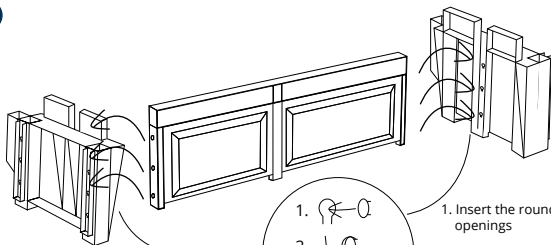

1. 
2. 
3. 

1. Insert the round tabs into the openings

2. Press the part down

3. Let it click into place.

Caution! The part may break if too much force is applied!

2

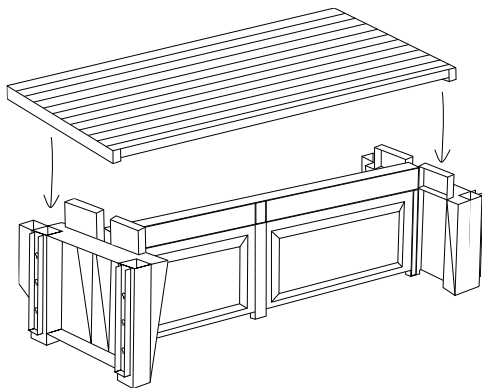

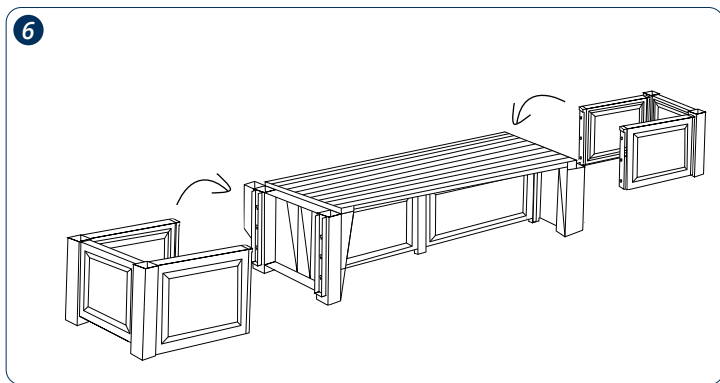
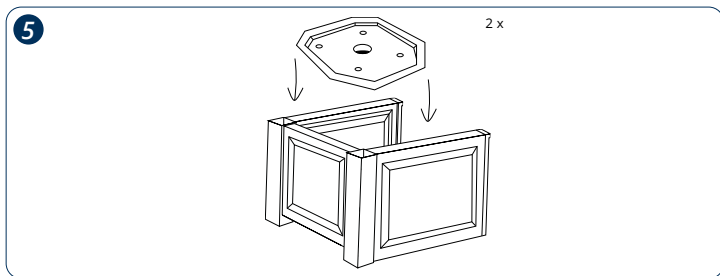
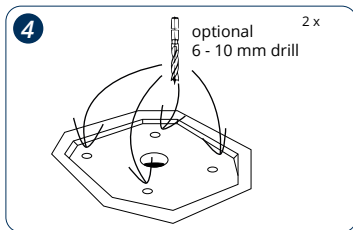
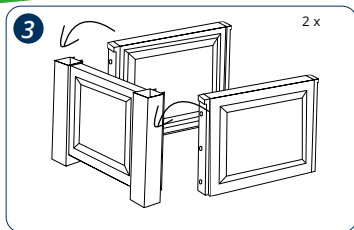

7

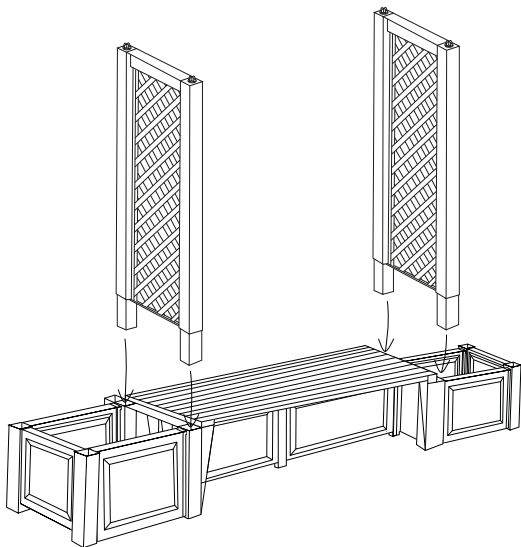

8

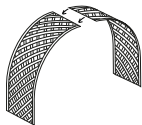

10

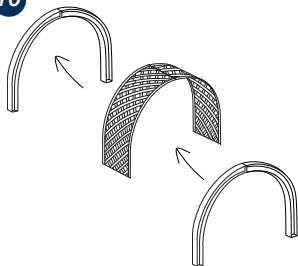

9

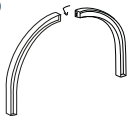

2 x

1. hold together
2. plug together

11

1. hold together
2. slide onto the cross dome, offset and from behind

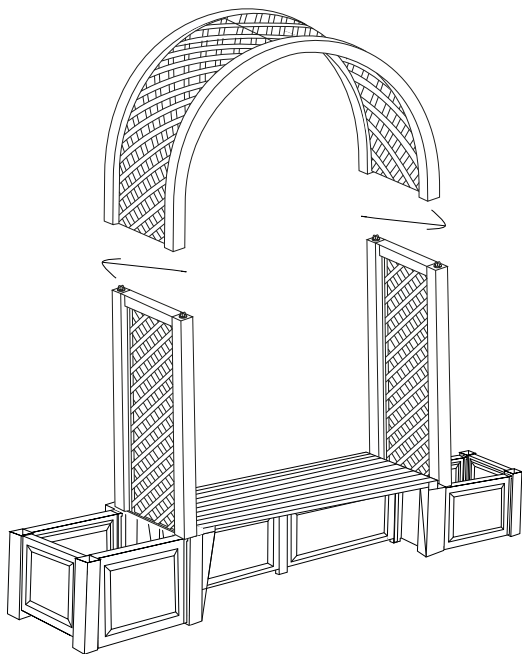

12

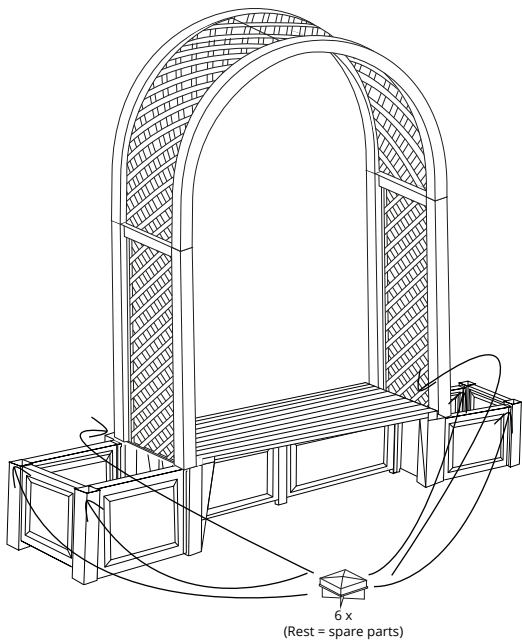

1 x sitting surface

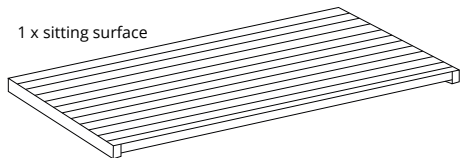

1 x bench side panel (right)

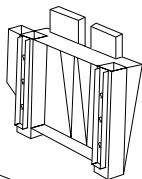

1 x bench centre

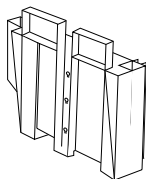
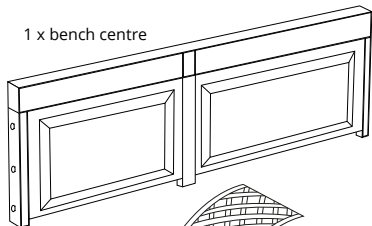

1 x bench side panel (left)

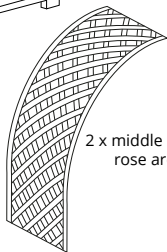

2 x middle panel, rose arch

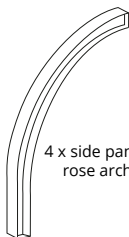

4 x side panel, rose arch

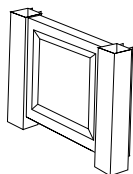

2 x side panel with post

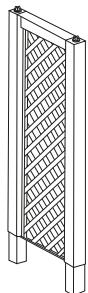

2 x small trellis

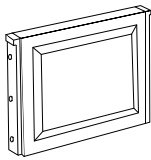

4 x side panel

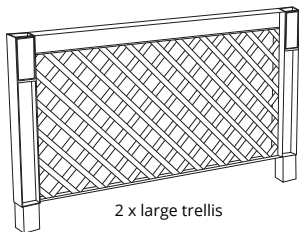

2 x large trellis



12 x cap

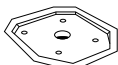

2 x base plate



4 x connector

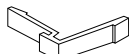

4 x corner connector

Aufbau

1

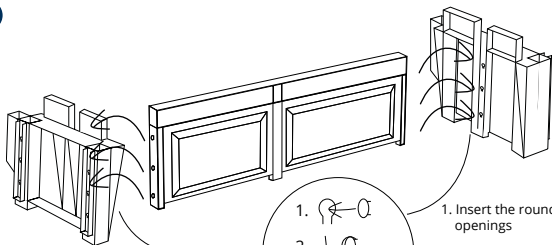

1. 
2. 
3. 

1. Insert the round tabs into the openings

2. Press the part down

3. Let it click into place.

Caution! The part may break if too much force is applied!

2

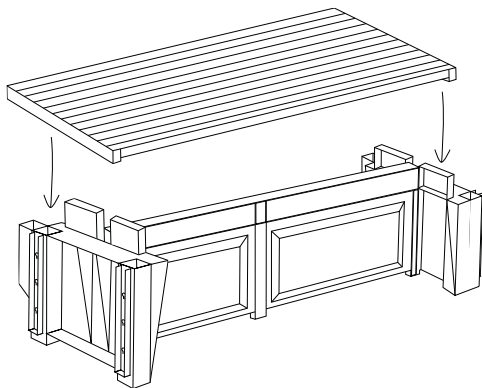

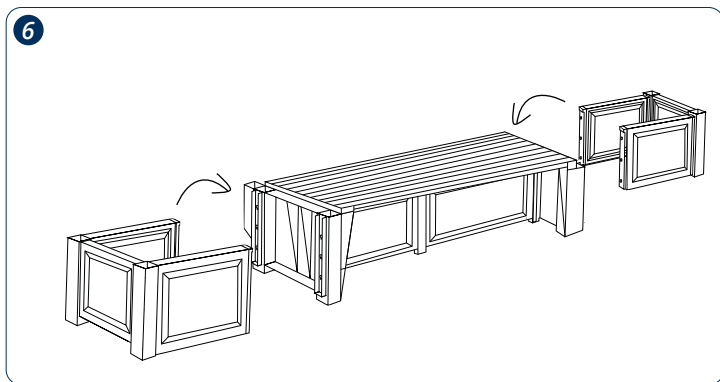
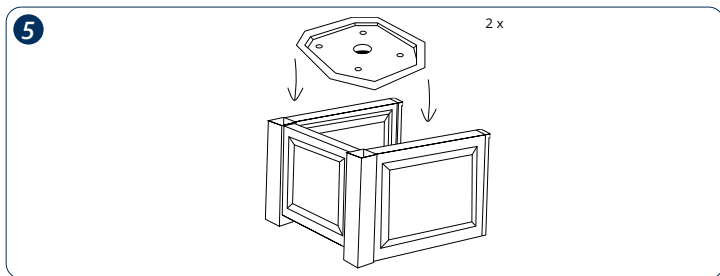
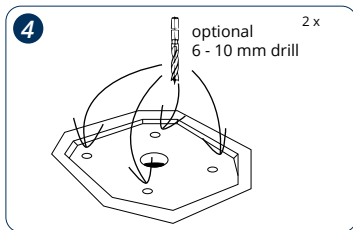
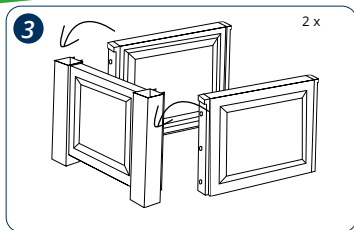

7

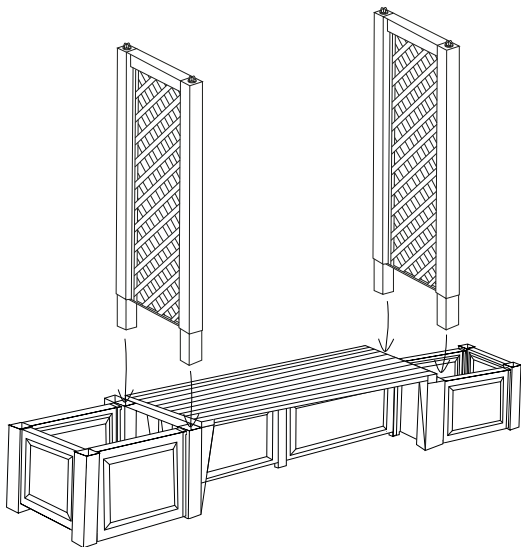

8

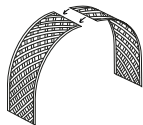

9

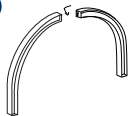

2 x

1. hold together
2. plug together

10

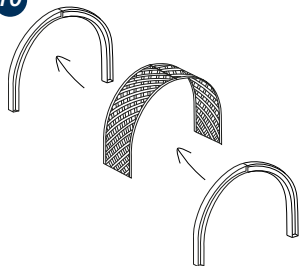

11

1. hold together
2. slide onto the cross dome, offset and from behind

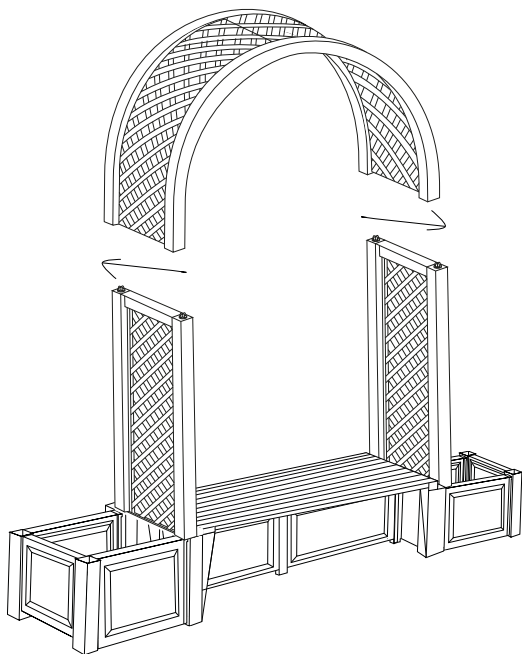

12

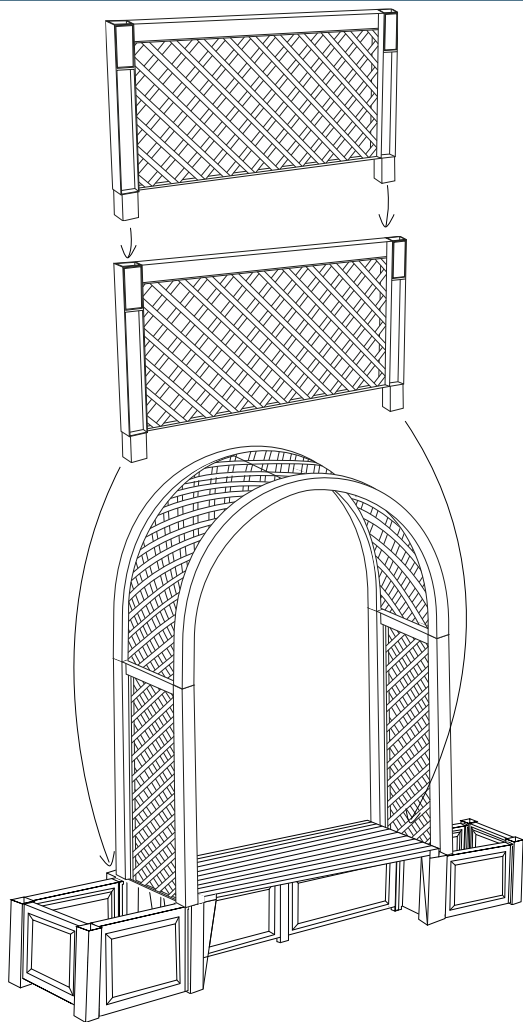

13

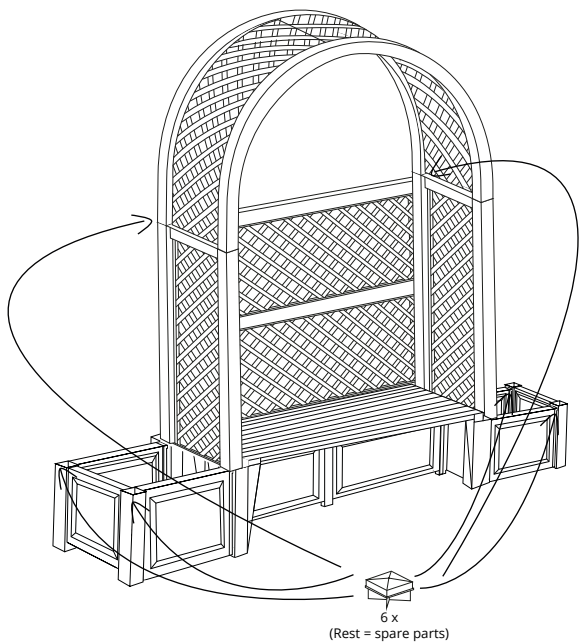

14

1. Connect the two large trellises together.
Orientate to the holes!



2 x
(Rest = spare parts)

2. Connect the large trellis and small trellis on both sides using the corner connectors.

Orientate to the holes!
See pictures below.

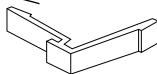

2 x
(Rest = spare parts)

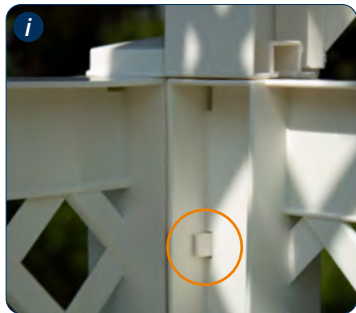

Plant and care instructions

- Select the **right potted plants** for your garden bench's **location**. Pay attention to whether it is sunny or more shaded there.
- Use **fresh, loose and well-aerated soil** that will retain water.
- Only water your plants in the early morning or evening hours, **ascertain the right amount while watering**, and pay attention to your potted plants' individual needs.
- **Fertilise** your container plants **regularly**.
- Pay attention to your plants and **check them regularly for pests or diseases**.
- The rose arch is an ideal support for **climbing plants**. If the plants are too heavy, they can also be **fastened** using **wire** or **ropes**.

We wish you the best of luck!



International version

To get the assembly instructions in another language **scan** the **QR code**.



Just as individual as you are!

As well as garden benches, we also have planters and trellises with the same design that you can **combine with one another** in your garden. There are no limits to your creativity!

Are you familiar with ...
our

Demeter raised bed?

Our raised garden bed is made of **100 percent recycled plastic** to help the environment, is **easy to care** for, **weather-proof** and is suitable for every garden thanks to its **simple and timeless design**.

Bon appetit!





We are also the right partner in winter!

On a sled from our **Junior** series, even the youngest children can have fun in the snow.

Later on, the models from the **Classic** range ensure speedy descents on the toboggan slope.

The sledges from the **Adventure** range are an intense experience for young and old.

Unsere Schlitten sind:

- made in Germany
- TÜV-tested
- free of harmful chemicals
- made of high-quality cold- and light-resistant plastic
- comfortable and ergonomic
- certified with the spiel gut seal*



Thank you for your trust in us!

Get 10% off in our online shop
www.schlittenmacher.de using
discount code **Bank10**

follow us on





KHW Kunststoff- und Holzverarbeitungswerk GmbH
Alte Lage 1a · 99331 Geratal OT Geschwenda

Telefon +49 3 62 05 - 7 49-0
Telefax +49 3 62 05 - 7 49 34

info@khw-geschwenda.de
www.khw-geschwenda.de



#gemeinsamspurenhinterlassen