

Calypso planter



assembly instructions

Thank you for choosing our Calypso planter.

The planter is made of **easy-care** and **weatherproof plastic**.

The **integrated irrigation system** provides optimum care for plants. The planter's **wheels** make transportation a cinch.

The assembly instructions are provided below. You also need a **6 - 10 mm drill bit**. Much of the assembly process involves simply interlocking the individual parts

Do not hesitate to contact us with any further inquiries:
service@khw-geschwenda.de

content

water level indicator

- 1 x black adapter
- 1 x red indicator including foam float
- 1 x 10 mm tube
- 1 x 25 mm tube

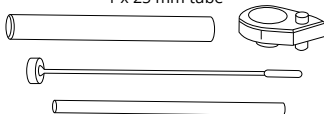

castor set

- 2 x castors
- 2 x castors with lock

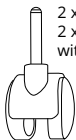

1 x base plate



4 x dowels

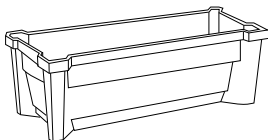

1 x box

1 x trellis

Art. 3730...

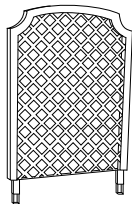

1 x modular trellis

Art. 3750...

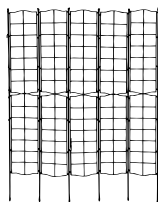

assembly

1

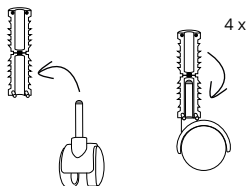

2

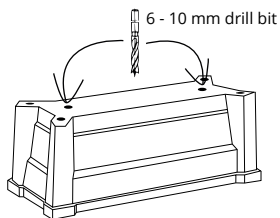

3

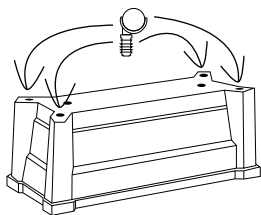

4

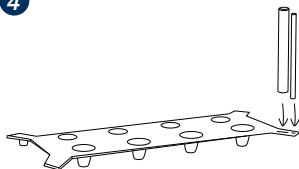

5

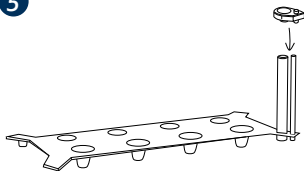

6

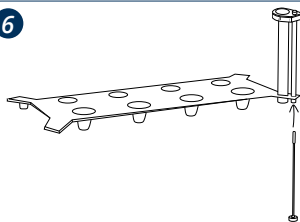

7

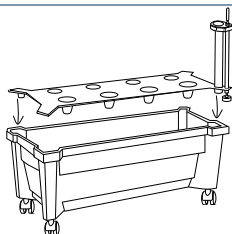

8

Art. 3730...

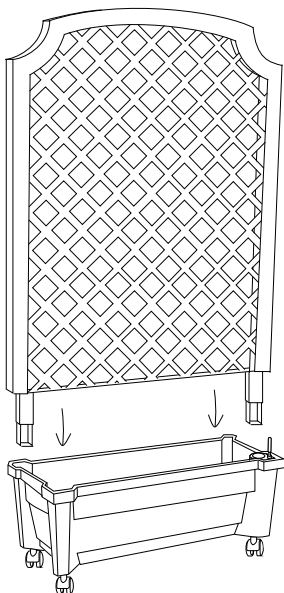

8

Art. 3750...

for assembling the
modular trellis see
separate instructions

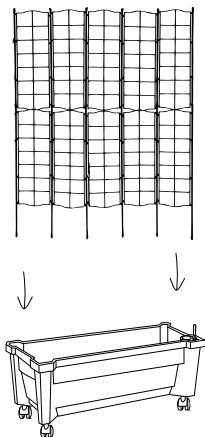

i

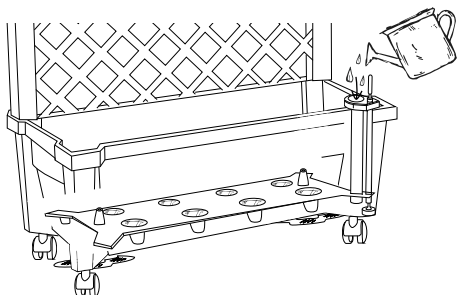

Planting and care instructions

- Select **suitable pot plants** for your Calypso's **location**. Is it sunny, shady, etc.?
- The best time to **plant** your plants in the planter is after the **Ice Saints**. If there is still a **risk of frost**, cover the plants with **garden fleece** or place them by a **sheltered wall**.
- Find the **right balance when watering** and pay attention to the individual needs of your pot plants.
- **Fertilise** your plants **regularly**.
- **Keep an eye** on your pot plants and regularly check them for **pests and diseases**.
- Protect your plants from frost by storing them in **cool, bright rooms during the winter**. The ideal temperature should be between **5 and 12°C**.

We wish you much success!



International version

To get the assembly instructions in another language **scan** the **QR code**.

As individual as you are!

You can **combine** as many Calypso planters as you like thanks to their **modular system**.

There are no limits to your planting ideas!

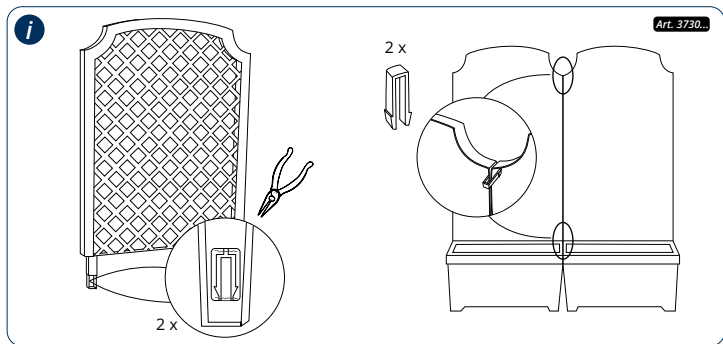

Are you familiar with ...

our
Demeter raised bed?

Our raised garden bed is made of **100 percent recycled plastic** to help the environment, is **easy to care** for, **weather-proof** and is suitable for every garden thanks to its **simple and timeless design**.

Bon appetit!





We are also the right partner in winter!

On a sled from our **Junior** series, even the youngest children can have fun in the snow.

Later on, the models from the **Classic** range ensure speedy descents on the toboggan slope.

The sledges from the **Adventure** range are an intense experience for young and old.

Our sleds are:

- made in Germany
- TÜV-tested
- free of harmful chemicals
- made of high-quality cold- and light-resistant plastic
- comfortable and ergonomic
- certified with the spiel gut seal*

follow us on



* this applies only to selected models



KHW Kunststoff- und Holzverarbeitungswerk GmbH
Alte Lage 1a · 99331 Geratal OT Geschwenda

Telefon +49 3 62 05 - 7 49-0
Telefax +49 3 62 05 - 7 49 34

info@khw-geschwenda.de
www.khw-geschwenda.de



#gemeinsamspurenhinterlassen